

SPECIFICATIONS

MAX VOLTAGE - 600VAC 3Φ
 RATED CURRENT - 600A
 STANDARDS - UL508A
 ENCLOSURE RATING - NEMA 4
 REF. ES11NFD3
 ENDURANCE - 3500 CYCLES
 EST. SHIPPING WEIGHT - 225LBS

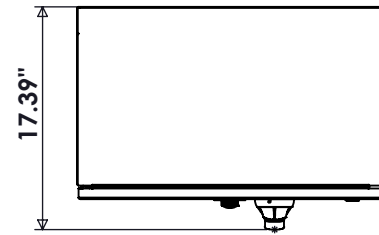

TOP VIEW

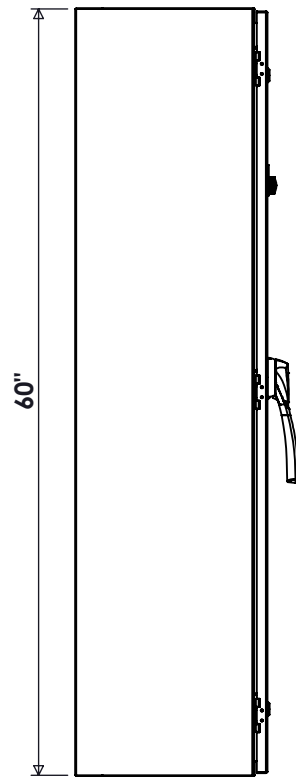

SIDE VIEW

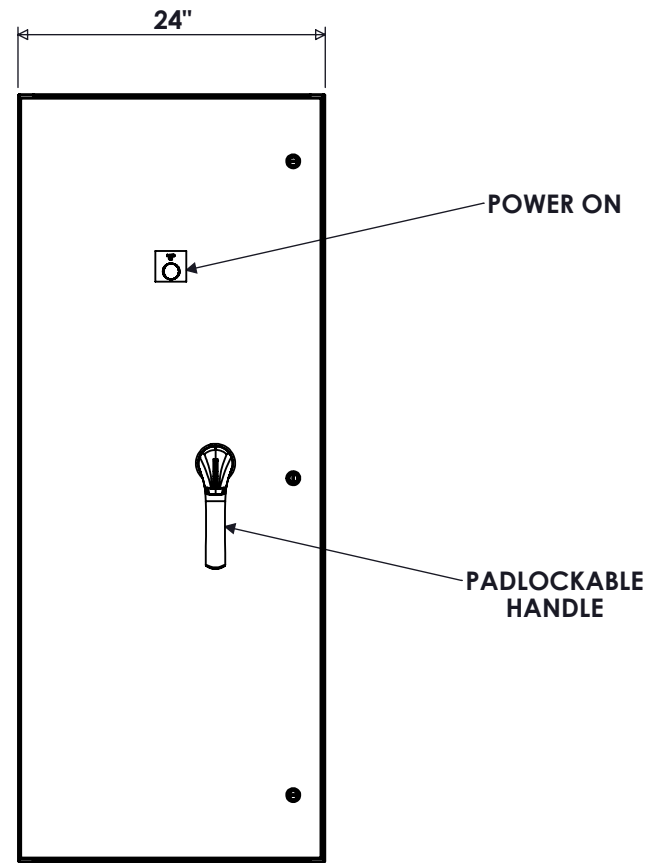

FRONT VIEW

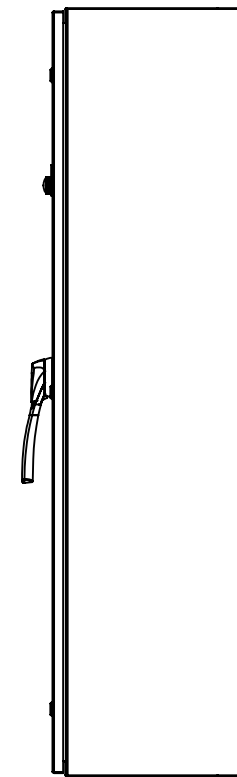

SIDE VIEW

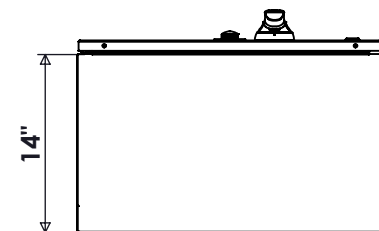

BOTTOM VIEW

CONNECTIONS

L1/L2/L3 - (2) #2-600MCM
 T1/T2/T3 - (2) #2-600MCM
 N - (2) #2-600MCM
 G - (1) #6-350MCM

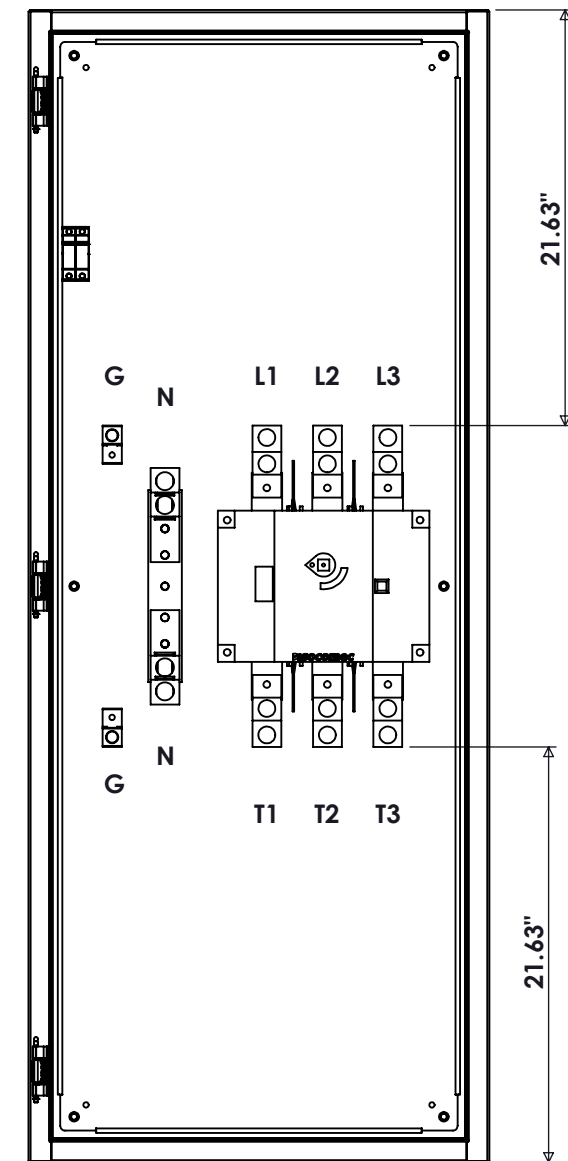

FRONT VIEW
DOOR REMOVED

NOTES

1: NEUTRAL KIT ONLY PRESENT IF PURCHASED



9900 TWIN LAKES PARKWAY
 CHARLOTTE, NC 28269
 704-596-5617
 PSICONTROLSOLUTIONS.COM

600A ENCLOSED NON-FUSIBLE DISCONNECT NEMA 4

REV	DESCRIPTION	DATE	DRAWN	S.RICHARDSON	
0	ORIGINAL RELEASE	11/14/16	CHECKED		
			SUP. NO		DRAWING TYPE
			SUP. BY NO		DIMENSIONAL
			PANEL NO		DRAWING NUMBER
			BUIL. NO		NFD600N4
			GROUP NO		
			ORDER NO		