

product specifications for: CLS Series 16 Inline Cams

Item #: CLS40MB

Description

MALE CLS SERIES 16 INLINE 2/0 - 4/0 AWG

Electrical Specifications

Max. Amperage: 400A with 4/0 AWG

Max. Voltage: 600V AC/DC

Material Specifications

Housing Material: Santoprene TPV

Contact Material: Brass

Temperature Rating: -40°C to 105°C

Mechanical Specification

Gender: Male

Connection Type: Double Set Screw

(Torque to 160 in-lbs.)

Retaining Screw: Glass Filled / Heat Stabilized Nylon

Example: CLS40MB + **A** = CLS40MB-A



Standards and Certifications

UL Listed: File E471676

CSA Certified: 0812900000

Environmental Rating: Type 3R & 4

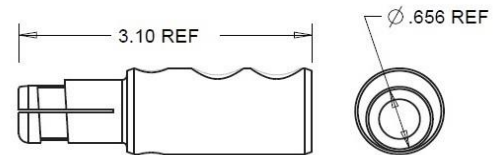
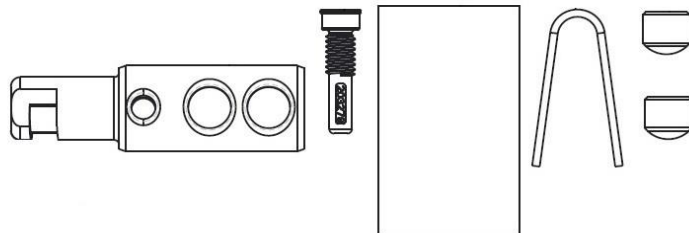
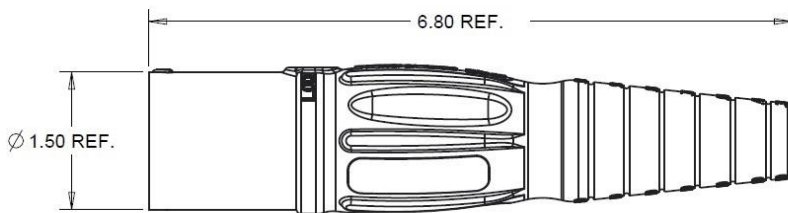

SHOWN FOR SIZING

toll free 800.307.6702 | marincopowerproducts.com

©2015 Marincó Power Products. All rights reserved.

MARINCO
power products